



Replacement Parts Suitable For:

**LINDE (L-Tec®)**



ORDER PART NO.	UNIT PRICE	DESCRIPTION	TIP I.D.	CONTACT TIPS & TIP ADAPTERS
PX19N45 PX19N46 PX19N47 PX19N48 PX19N49 PX19N50 PX19N764 PX19N120	\$7.02 EA \$7.02 EA \$7.02 EA \$7.02 EA \$7.02 EA \$7.02 EA \$7.02 EA \$7.02 EA	Contact Tip 1/16" Contact Tip 5/64" Contact Tip 3/32" Contact Tip 1/8" Contact Tip 5/32" Contact Tip 3/16" Contact Tip 7/64" Contact Tip .120	.078 .093 .108 .140 .171 .203 .125 .1285	 (Used with 28V38 and 28V25)
PX49N44 PX55N06	\$1.95 EA \$1.95 EA	Contact Tip .035 Contact Tip .045	.043 .061	(Used with ST-9)
PX55N05	\$1.95 EA	Contact Tip .035	.043	(Used with ST-9)
PX61N36 PX61N37 PX61N38 PX61N39 PX61N40 PX61N41 PX61N42 PX61N564	\$3.95 EA \$3.95 EA \$3.95 EA \$3.95 EA \$3.95 EA \$3.95 EA \$3.95 EA \$3.95 EA	Contact Tip .035 Contact Tip .045 Contact Tip 3/64" Contact Tip 1/16" Contact Tip 1/16" Contact Tip 3/32" Contact Tip 3/32" Contact Tip 5/64"	.046 .057 .063 .071 .081 .105 .120 .093	 (Used with ST-12)
PX61N45 PX61N46 PX61N47 PX61N48	\$3.95 EA \$3.95 EA \$3.95 EA \$3.95 EA	Contact Tip 3/32" Contact Tip 3/32" Contact Tip 1/8" Contact Tip 1/8"	.105 .120 .136 .152	 (Used with ST-12)
PX948832 PX948833	\$3.55 EA \$3.55 EA	5/64" cored 3/32" cored	.093 .110	 (Used on MT-500M)
PX17765 PX17778 PX948835	\$3.95 EA \$3.95 EA \$3.95 EA	.045-3/64" Hard .052 Hard 1/16" Hard	.054 .063 .078	 (Used with ST-9 & MT-500M)
PX409052 PX568612 PX568613	\$9.50 EA \$9.50 EA \$9.50 EA	Contact Tip .052 Contact Tip 1/16" Contact Tip 3/32"	.052 .078 .109	 (Used with ST-14)
PX632793 PX632795 PX632797 PX632799 PX632800	\$1.95 EA \$1.95 EA \$1.95 EA \$1.95 EA \$1.95 EA	Contact Tip .035 Contact Tip .045 Contact Tip 1/16" Contact Tip 5/64" Contact Tip 3/32"	.044 .060 .078 .093 .109	 (Used with ST-16, ST-21 and MT-450W)
PX632794 PX632796 PX632798	\$1.95 EA \$1.95 EA \$1.95 EA	Contact Tip .035 Contact Tip .045 Contact Tip 1/16"	.044 .060 .078	 (Used with ST-16, ST-21 and MT-450W)
PX633108 PX633109 PX633110 PX633116	\$1.95 EA \$1.95 EA \$1.95 EA \$1.95 EA	Contact Tip .035 Contact Tip .045 Contact Tip 1/16" Contact Tip .030	.044 .059 .081 .038	 (Used on ST-23A)
PX17766 PX948786	\$11.95 EA \$9.95 EA	.045 - 1/16" 5/64" - 3/32" Tip Adapters for use with 17318		 (Used on MT-200, MT-200CC, MT-400 and MT-400CC)
PX948785	\$9.95 EA	Tip Adapters for use with 17318		 (Used on MT-200, MT-200CC, MT-400 and MT-400CC)
PX17983	\$11.95 EA	Tip Adapters for use with 999452		 (Used on MT-200, MT-200CC, MT-400 and MT-400CC)
PX17984	\$15.95 EA	Tip adapter for use with 999452		 (Used on MT-200, MT-200CC, MT-400 and MT-400CC)

ORDER PART NO.	UNIT PRICE	DESCRIPTION	NOZZLES, TIP NUT, ADAPTERS
PX61N26	\$19.95 EA	Nozzle	 (Used with ST-12)
PX598721	\$10.95 EA	Nozzle 5/8"	 (Used with ST-16 & ST-21)
PX598739	\$10.95 EA	Nozzle 1/2"	 (Used with ST-16 & ST-21)
PX19N43	\$4.95 EA	Tip Nut	 (UWM-8 / SWM-9) (Used with 28V38 Busbar and Straight Nozzle Assy. & 28V25 Busbar and Curved Nozzle Assy.)
PX999452	\$6.90 EA	Nozzle Adapter	 (Used on MT-200, M7 200CC, MT-400 and MT-400CC)
PX17318	\$24.94 EA	Extra Heavy Duty Adapter	 (Used with MT-400 & MT-400CC)

**SUB ARC PRODUCTS**

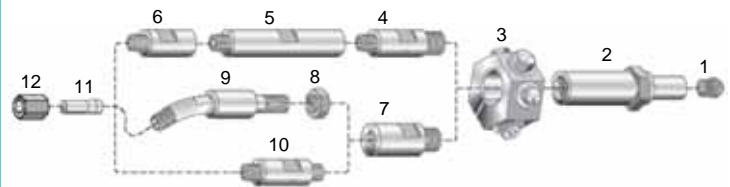

**(EH-1, EH-2, EH-10, EH-11 & UMA2 Welding Heads)**

ORDER PART NO.	UNIT PRICE	DESCRIPTION	KEY NO.
PX28N31	\$26.04 EA	Busbar Wire Guide	1.
PX29N20	\$96.00 EA	Busbar Adapter	2.
PX29N19	\$150.22 EA	Busbar	3.
PX29N21	\$49.78 EA	Busbar, Converting Nozzle	4.
PX41W30	\$50.61 EA	5" Busbar Extension	5.
PX41W98	\$37.93 EA	2" Busbar Extension	6.
PX29N22	\$52.15 EA	2" Adapter, Extension	7.
PX63140229	\$0.75 EA	Jam Nut 5/8 - 11	8.
PX19V50	\$60.71 EA	Curved Nozzle Assembly 1/16"	9.
PX19V51	\$60.71 EA	Curved Nozzle Assembly 3/16"	
PX19V52	\$60.71 EA	Curved Nozzle Assembly 3/32"-5/32"	
PX16N39	\$57.84 EA	Straight Nozzle	10.
PX19N*	ABOVE 19N Series	Contact Tips	11.
PX999398	\$6.30 EA	Tip Nut	12.

SIWS is in no way affiliated with PROFAX or ESAB (L-Tec)(AIRCO). The parts advertised for sale are not genuine ESAB (L-Tec)(AIRCO) parts, but are parts made for and by PROFAX. References to ESAB (L-Tec)(AIRCO) machines, torches and numbers are for your convenience only. We reserve the right to substitute genuine PROFAX or ESAB (L-Tec)(AIRCO) parts in place of PROFAX parts.