

**\$ FOR PRICE LISTING
GO TO PAGE 317**

PLASMA CUTTING

Replacement Parts

Suitable For

ESAB® (L-TEC® / Linde®)

Torch Model	Power Supply Model
PT-13, PT-14, PT-101	n/a

- T-210 Tip, .070, CCW, 100 amp argon/hydrogen
- T-209 Tip, .070, 100 amp (rev. swirl) argon/hydrogen
- T-208 Tip, .030, CCW (reverse swirl)
- T-207 Tip, .030
- T-206 Tip, .046, CCW (reverse swirl)
- T-205 Tip, .046
- T-204 Tip, .059, CCW (reverse swirl) lo-amp
- T-203 Tip, .059, lo-amp

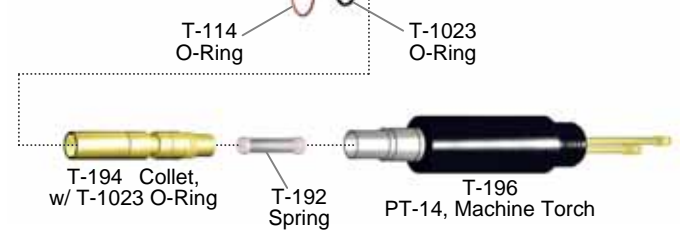
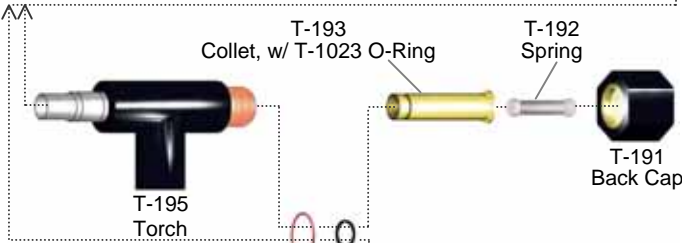
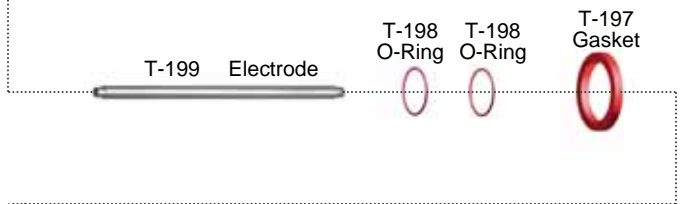
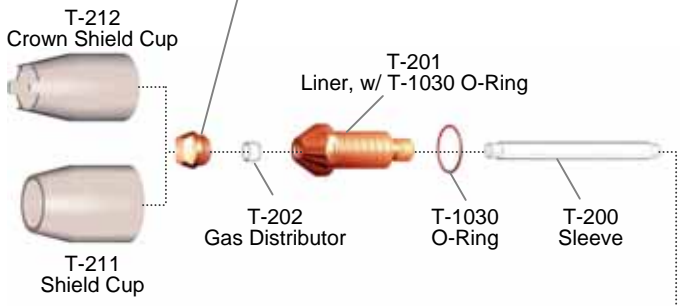

REQUIREMENTS:
 Plasma Gas – N₂ at 30 psi (2.2 kg/cm²), 15 SCFH (7.1 l/m).
 Secondary Gas – CO₂ or Compressed Air at 50 psi (3.52 kg/cm²), 250 SCFH (125.0 l/m)

ADDITIONAL ITEMS NOT SHOWN

- | | |
|-----------------|---------------------|
| T-163 Lubricant | T-215 Liner Wrench |
| | T-214 Collet Wrench |
| | T-213 Tip Wrench |
| | T-837 O-ring Tool |



ACCESSORIES Suitable For

ESAB® (L-TEC® / Linde®)

Torch Model	Power Supply Model
PT-13, PT-14, PT-101	n/a

HAND TORCH

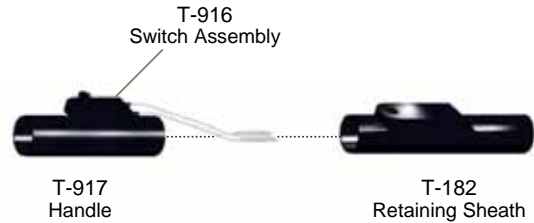

MACHINE TORCH

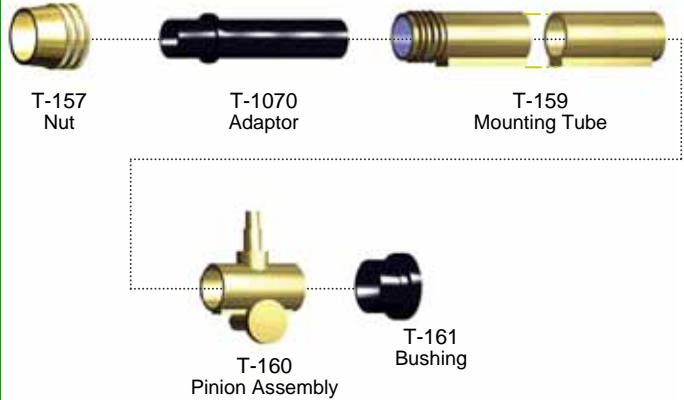

LEADS COMPLETE

- T-908 Hand Leads, 25'
- T-909 Machine Leads, 25'
- T-910 Hand Leads, 50'
- T-1036 Machine Leads, 50'

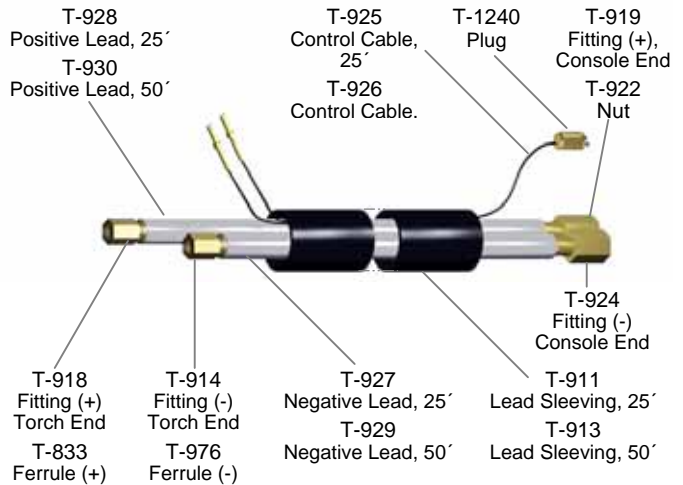

ADDITIONAL ITEMS NOT SHOWN

- T-912 3" Shrink-On Tubing
- T-920 Heat Shield

Stoody Industrial & Welding Supply, Inc. (SIWS) is not associated with STOODY Company or any of the above manufacturers. SIWS reserves the right to substitute OEM products in place of parts shown.