



FOR PRICE LISTING
GO TO PAGE 317

PLASMA CUTTING

Replacement Parts

Suitable For

Thermal Dynamics Corp.®

Torch Model Power Supply Model

PCH-26, PCH/M-28 ECONO-PAK®50, PAKMASTER® 50XL, PAKMASTER® 50XL PLUS

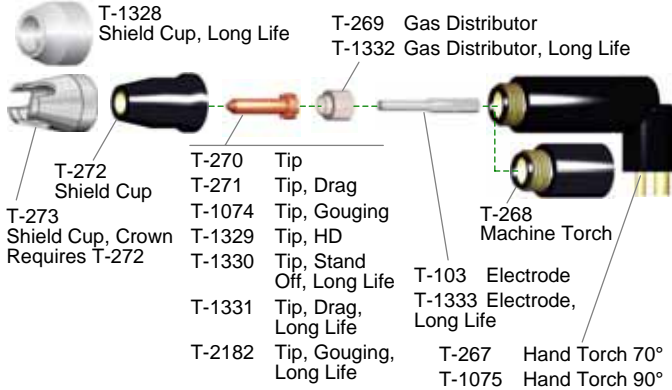

Long life parts cannot be used mixed with standard parts.

Accessories Suitable For

Thermal Dynamics Corp.®

Torch Model Power Supply Model

PCH/M-28 PAKMASTER®50XL, PAKMASTER®50XL PLUS

HAND TORCH

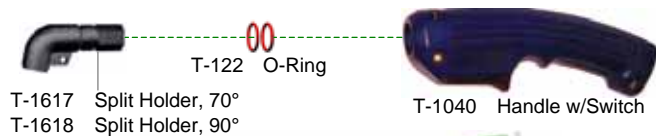

MACHINE TORCH

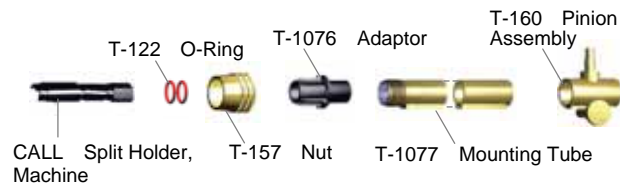

ITEMS NOT SHOWN:

- T-1621 Spring
- T-874 Handle
- T-2141 Switch (for T-874)
- T-155 Retaining Sheath
- T-2285 70 Torch w/12.5' Leads, E-PAK
- T-2286 70 Torch w/ 25' Leads, E-PAK
- T-2287 90 Torch w/ 12.5' Leads, E-PAK
- T-2288 90 Torch w/ 25' Leads, E-PAK
- T-734 70 Torch w/ 25' Leads, PKMSTR®
- T-735 70 Torch w/ 50' Leads, PKMSTR®
- T-2892 90 Torch w/ 25' Leads, PKMSTR®

Note: Verify Power Supply When Ordering

Pakmaster®, Econo-Pak® are the Registered Trademarks of Thermal Dynamics Corp.

Suitable For

Thermal Dynamics Corp.®

Torch Model Power Supply Model

PCH/M30 (PAK 3)

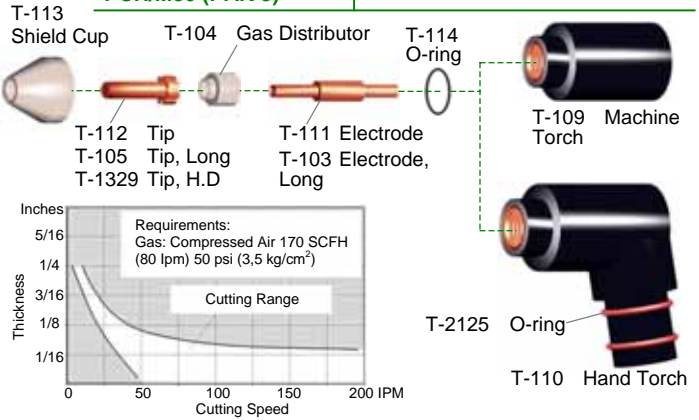

Accessories Suitable For

Thermal Dynamics Corp.®

Torch Model Power Supply Model

PCH/M30 (PAK 3)

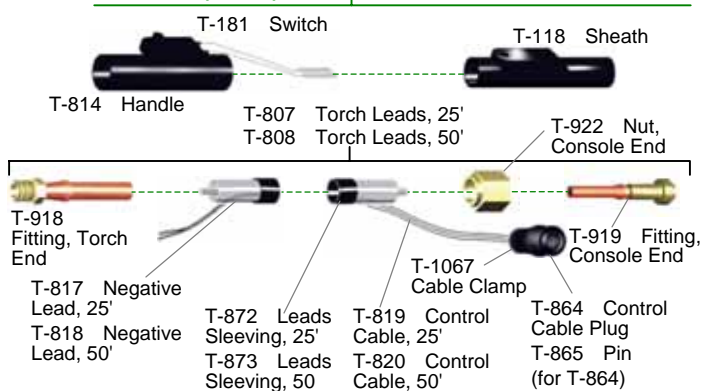

Suitable For

Thermal Dynamics Corp.®

Torch Model Power Supply Model

PCH/M-35 STAKPAK PAKMASTER 50

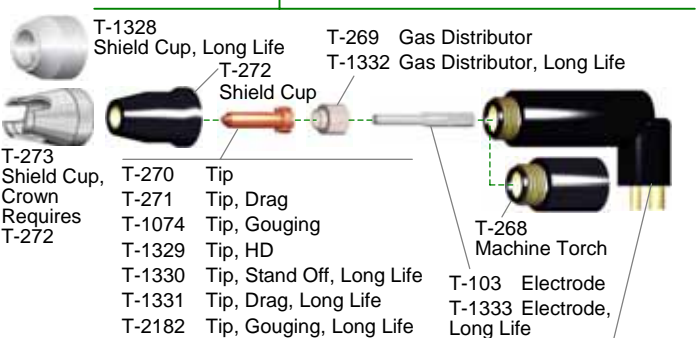

REQUIREMENTS:
Gas: Compressed Air
Pressure: 70 psi (4.8 BAR)
Flow: 200 scfh (94.4 lpm) for cutting

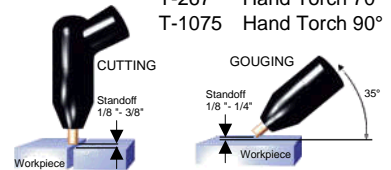
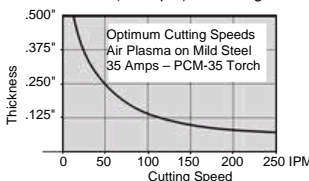

Long life parts cannot be used mixed with standard parts.