



FOR PRICE LISTING  
GO TO PAGE 317

# PLASMA CUTTING

Replacement Parts

Accessories Suitable For

## Thermal Dynamics Corp.®

Torch Model Power Supply Model

PCH/M-35

STAKPAK PAKMASTER 50

### MACHINE TORCH

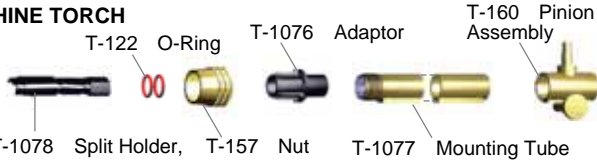

### HAND TORCH

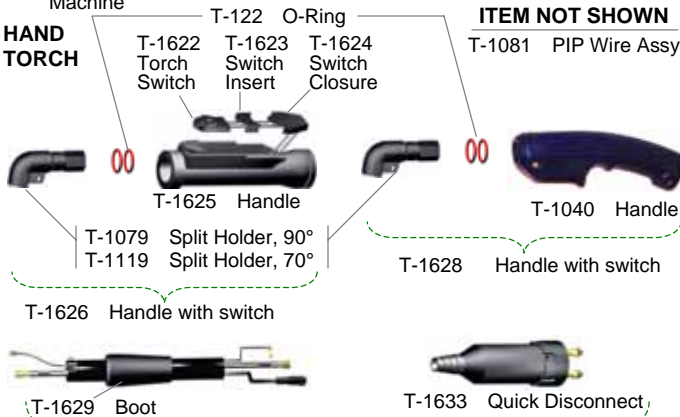

ITEM NOT SHOWN

- T-1626 Handle with switch
- T-1629 Boot
- T-1634 Leads w/QD, 12.5'
- T-1635 Leads w/QD, 25'
- T-1636 Leads w/QD, 50'
- T-1921 70° Torch w/12.5' Leads & QD
- T-1922 70° Torch w/25' Leads & QD
- T-1923 70° Torch w/50';Leads & QD
- T-1924 (90) Torch w/12.5' Leads & QD
- T-1925 (90) Torch w/25' Leads & QD
- T-1926 (90) Torch w/50' Leads & QD

Suitable For

## Thermal Dynamics Corp.®

Torch Model Power Supply Model

PCH/M-40

PAKMASTE®R 50XL & 50XL PLUS

(See PCH/M-35) Uses T-267; T-268; T-272; T-273; T-1075; T-1328; T-1330; T-1331; T-1332; T-1333, & T-2182

Suitable For

## Thermal Dynamics Corp.®

Torch Model Power Supply Model

PCH-50

PAK 5

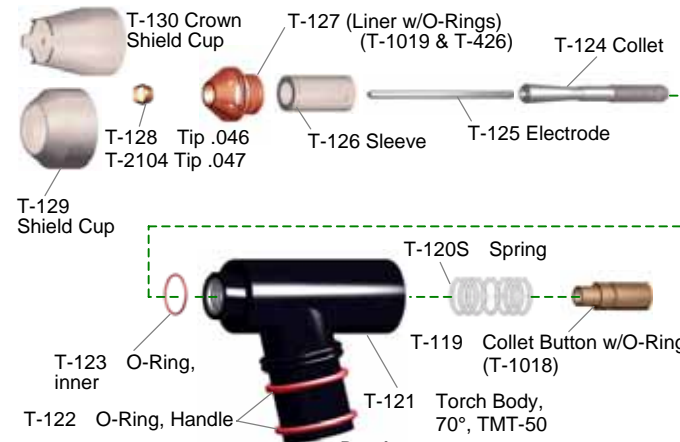

**Requirements:**  
Plasma Gas: Nitrogen @ 30 psi (2.2 kg/cm<sup>2</sup>), 20 SCFH (9.4 lpm)  
Compressed Air @ 50 psi (3.5 kg/cm<sup>2</sup>), 110 SCFH (51.9 lpm)

Accessories Suitable For

## Thermal Dynamics Corp.®

Torch Model Power Supply Model

PCH-50

PAK 5

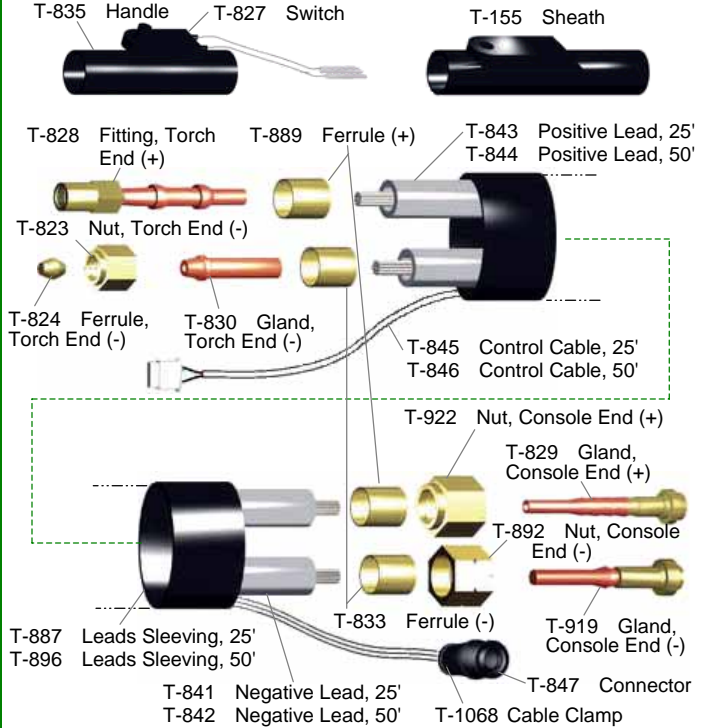

ITEMS NOT SHOWN

- T-189 Liner wrench
- T-836 Tip wrench
- T-837 O-ring tool
- T-163 Lubricant



Suitable For

## Thermal Dynamics Corp.®

Torch Model Power Supply Model

PCH/M-51

PAK 3XR, 4XI, 5XT, 5XR, 6XI, 625XR, 750XR

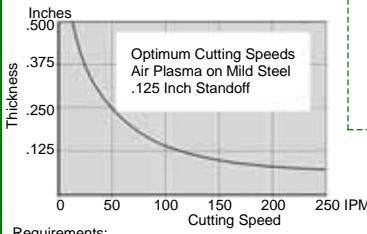
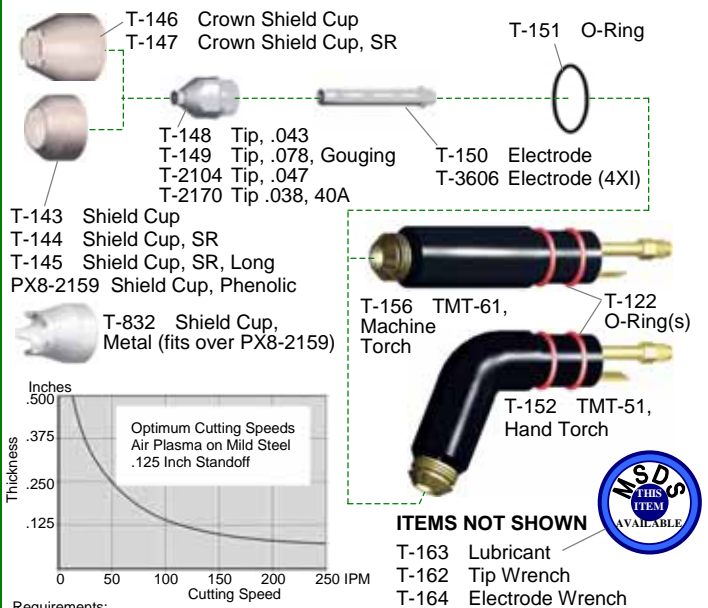

**Requirements:**  
Compressed Air = 300 scfh (113 lpm)  
At 50 psi (3.4 BAR)

ITEMS NOT SHOWN

- T-163 Lubricant
- T-162 Tip Wrench
- T-164 Electrode Wrench

