



FOR PRICE LISTING
GO TO PAGE 317

PLASMA CUTTING

Replacement Parts

Suitable For

Thermal Dynamics Corp.®

Torch Model Power Supply Model

PCH/M-75, PCH/M-60,
PCH/M-80

PAKMASTER® 75, ECONO-PAK™100
PAKMASTER® 75XL PLUS
PAKMASTER® 100XL PLUS

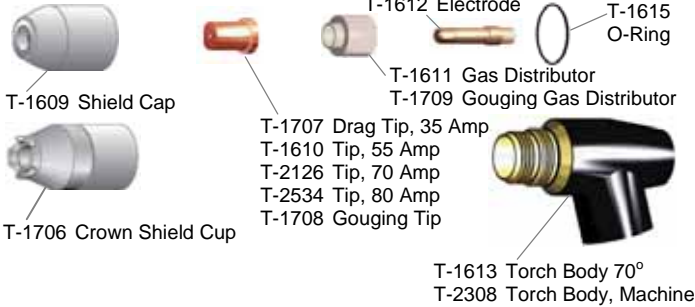

Accessories Suitable For

Thermal Dynamics Corp.®

Torch Model Power Supply Model

PCH/M-75, PCH/M-60,
PCH/M-80

PAKMASTER® 75, ECONO-PAK™100
PAKMASTER® 75XL PLUS
PAKMASTER® 100XL PLUS

MACHINE TORCH



HAND TORCH

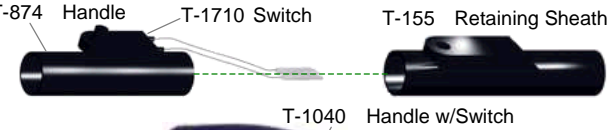

T-1711 Hand Leads, Unshielded, 25'
T-1712 Hand Leads, Unshielded, 50'
T-1713 Machine Leads, Unshielded, 25'
T-1714 Machine Leads, Unshielded, 50'

Suitable For

Thermal Dynamics Corp.®

Torch Model Power Supply Model

PCH/M-100

PAK®10XR

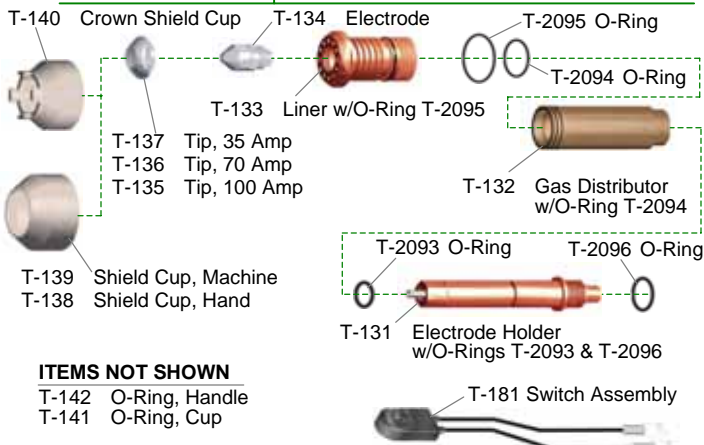

ITEMS NOT SHOWN

T-142 O-Ring, Handle
T-141 O-Ring, Cup

Accessories Suitable For

Thermal Dynamics Corp.®

Torch Model Power Supply Model

PCH/M-102

75XL PLUS 60 AMP, 100XL
PLUS 80 AMP AND
CUTMASTER 75)

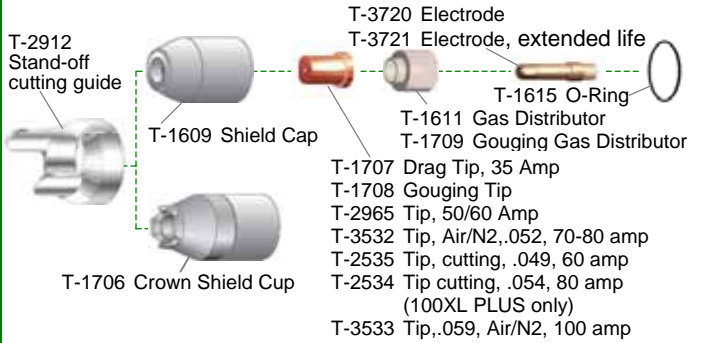

Accessories Suitable For

Thermal Dynamics Corp.®

Torch Model Power Supply Model

PCH/M-120

(PAKMASTER 150XL)



Accessories Suitable For

Thermal Dynamics Corp.®

Torch Model Power Supply Model

PCH/M-140

STAK PAK®

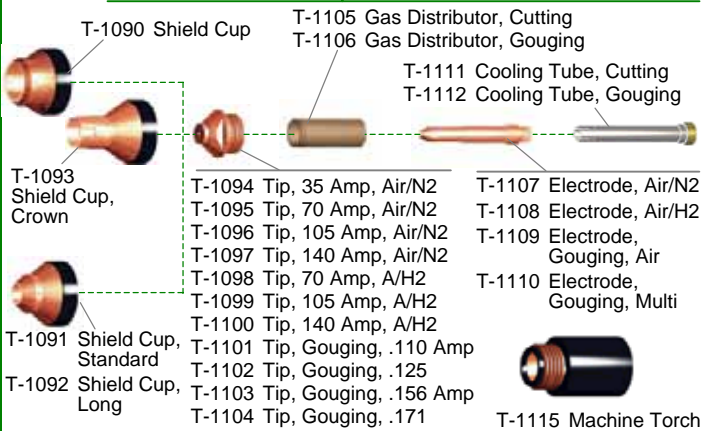

REQUIREMENTS; Plasma Gases
Compressed Air, Nitrogen, Argon/Hydrogen
Plasma Gas Pressure:
STAK PAK® 50 psi (3.4 bar)
XR Units 40 psi (2.8 bar)
Flow Requirements:
Cutting 22 - 28 scfh (10.4 - 13.2 lpm)
Gouging 22 - 43 scfh (10.4 - 20.3 lpm)

REQUIREMENTS; Secondary Gases
Compressed Air, Nitrogen, Carbon Dioxide
Secondary Gas Pressure: Cutting or Gouging
60 - 75 psi (4.1 - 5.2 BAR)
Secondary Gas Flow: Cutting or Gouging
470 - 600 scfh (220 - 281 lpm)

